

INTERIOR INSTALLATION

HunterDouglas 
Ceiling & Wall Products
exclusively from CertainTeed

5015 Oakbrook Parkway, Suite 100
Norcross, GA 30093
O 800.366.4327
F 770.806.0214
CTSpecialtyCeilings.com

All rights reserved. This drawing is the property of CertainTeed Ceilings Corporation. It may not be copied or multiplied, neither wholly nor partly. It may not be submitted for perusal to third parties.

SPECIFICATIONS (unless noted otherwise)

MATERIAL: .028" ALUMINUM 300C PANEL | .040" ALUMINUM 300C CARRIER
FINISH: PAINT | POWDER COAT | DECORATED WOOD FINISH | WOOD
VENEER | LUXACOTE
PERFORATION: NON-PERFORATED | #160

OVERALL ISOMETRIC VIEW

PROJECT: 300C PRODUCT SPECIFICATIONS
DRAWING NUMBER: 300C-A1.0
SCALE: 3" = 1'-0"
DRAWN BY: HD ENGINEERING
DATE: 1/28/19

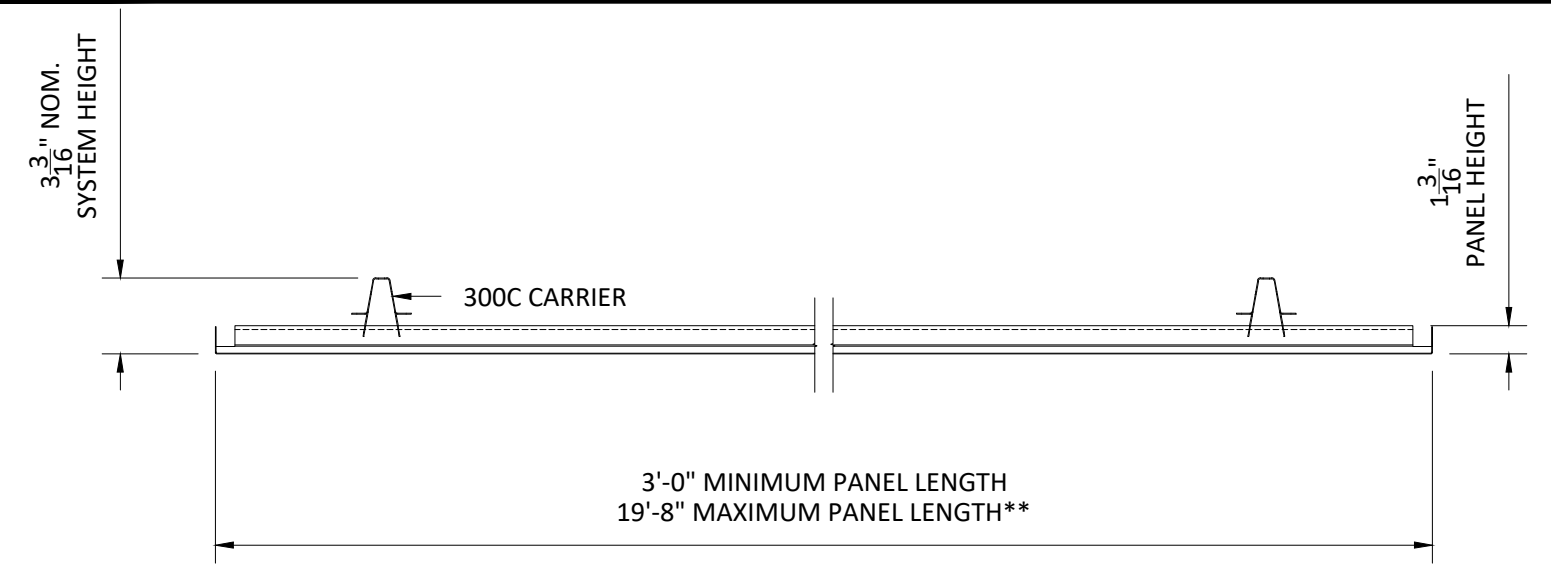

FACTORY PANEL SIDE VIEW

*VERTICAL SUPPORT OMITTED FOR CLARITY
**PANEL LENGTHS VARIABLE IN 1/8" INCREMENTS, TOLERANCE ±1/8"

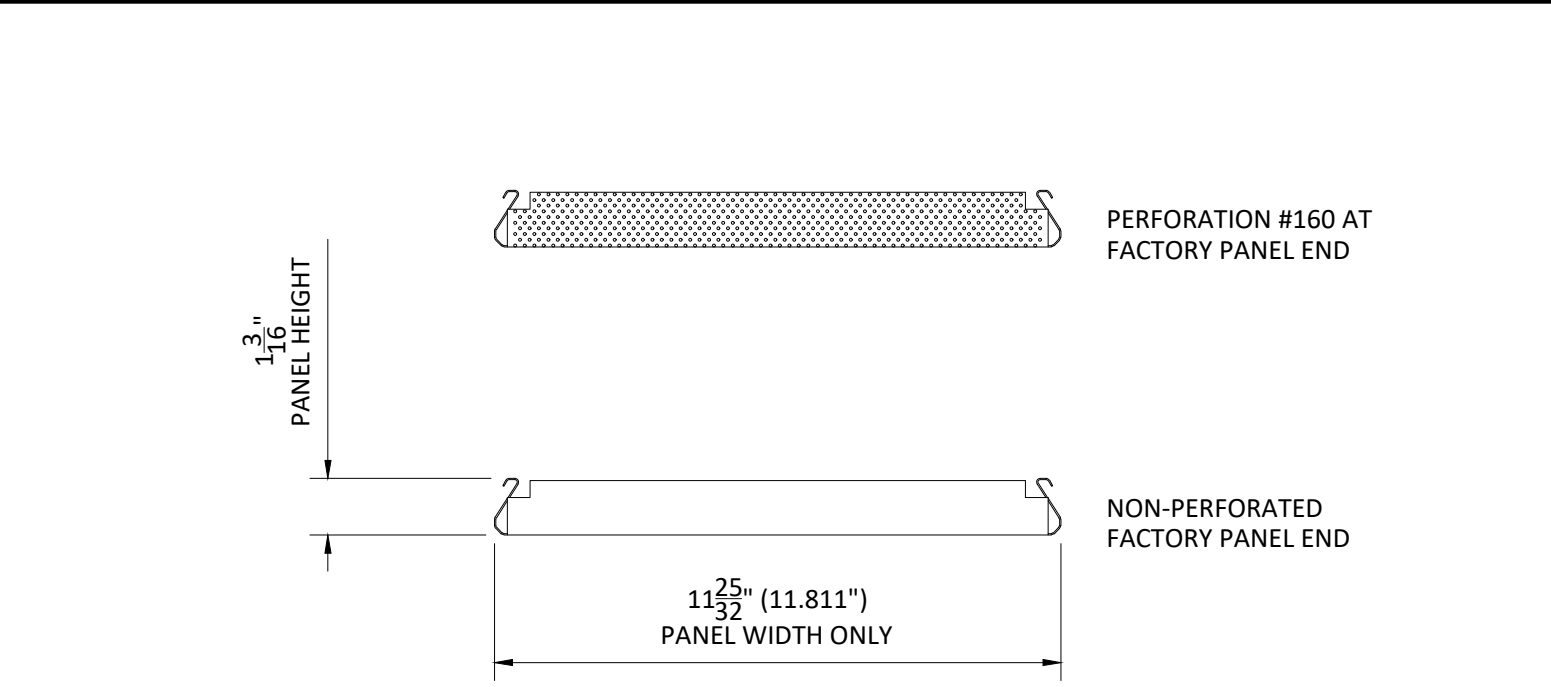

FACTORY PANEL ENDS

*SUSPENSION OMITTED FOR CLARITY

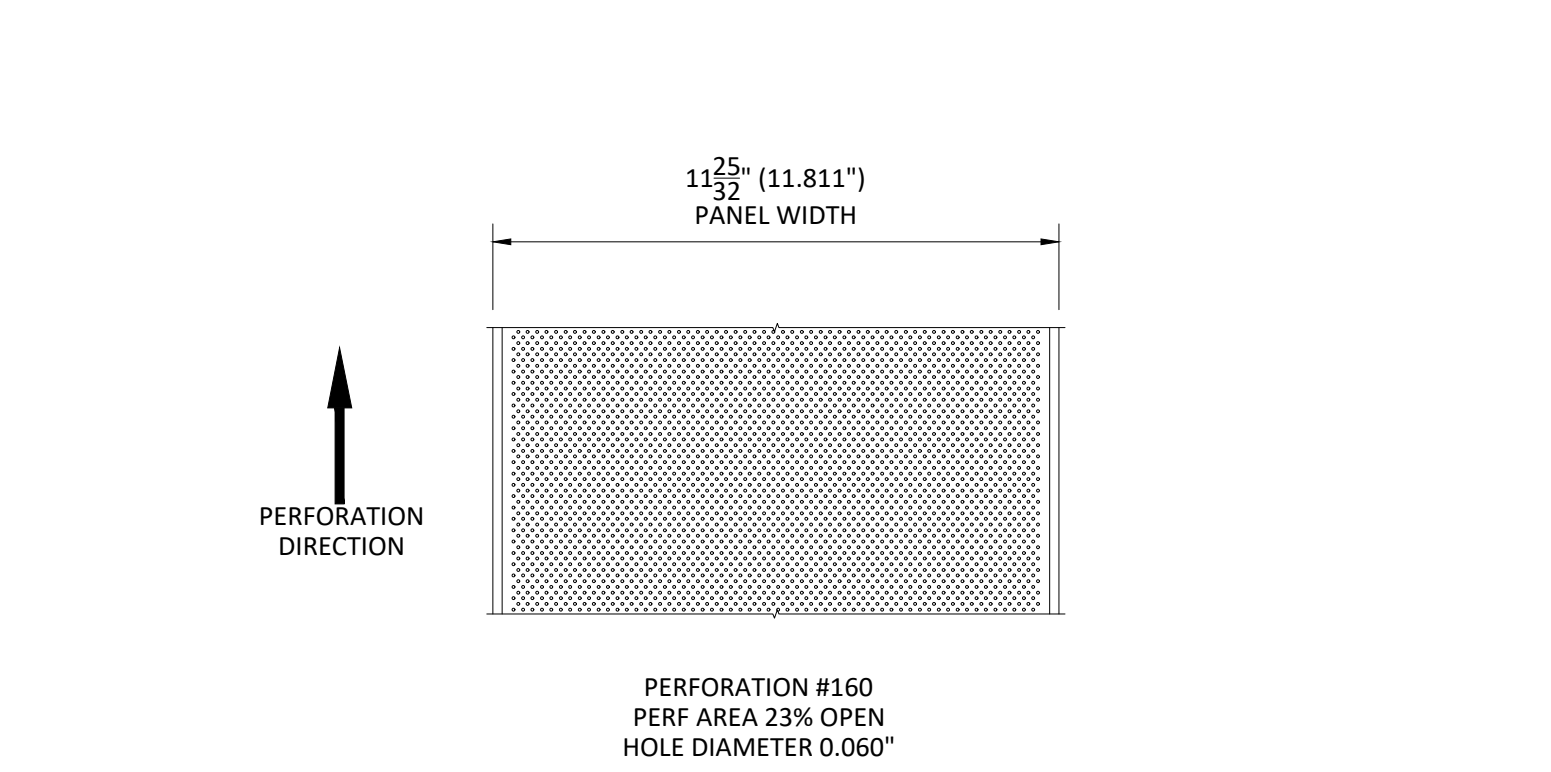

AVAILABLE PANEL PERFORATION

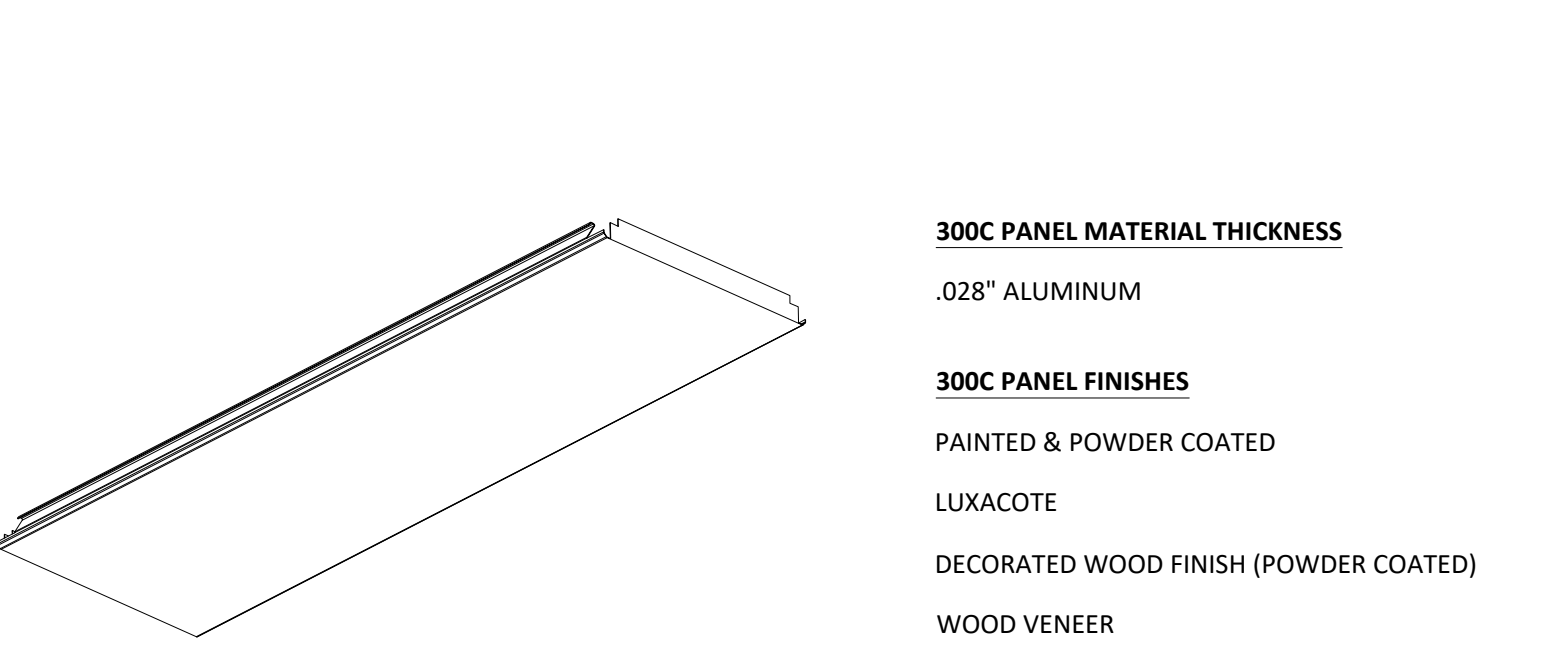

300C PANEL MATERIAL THICKNESS

.028" ALUMINUM

300C PANEL FINISHES

- PAINTED & POWDER COATED
- LUXACOTE
- DECORATED WOOD FINISH (POWDER COATED)
- WOOD VENEER

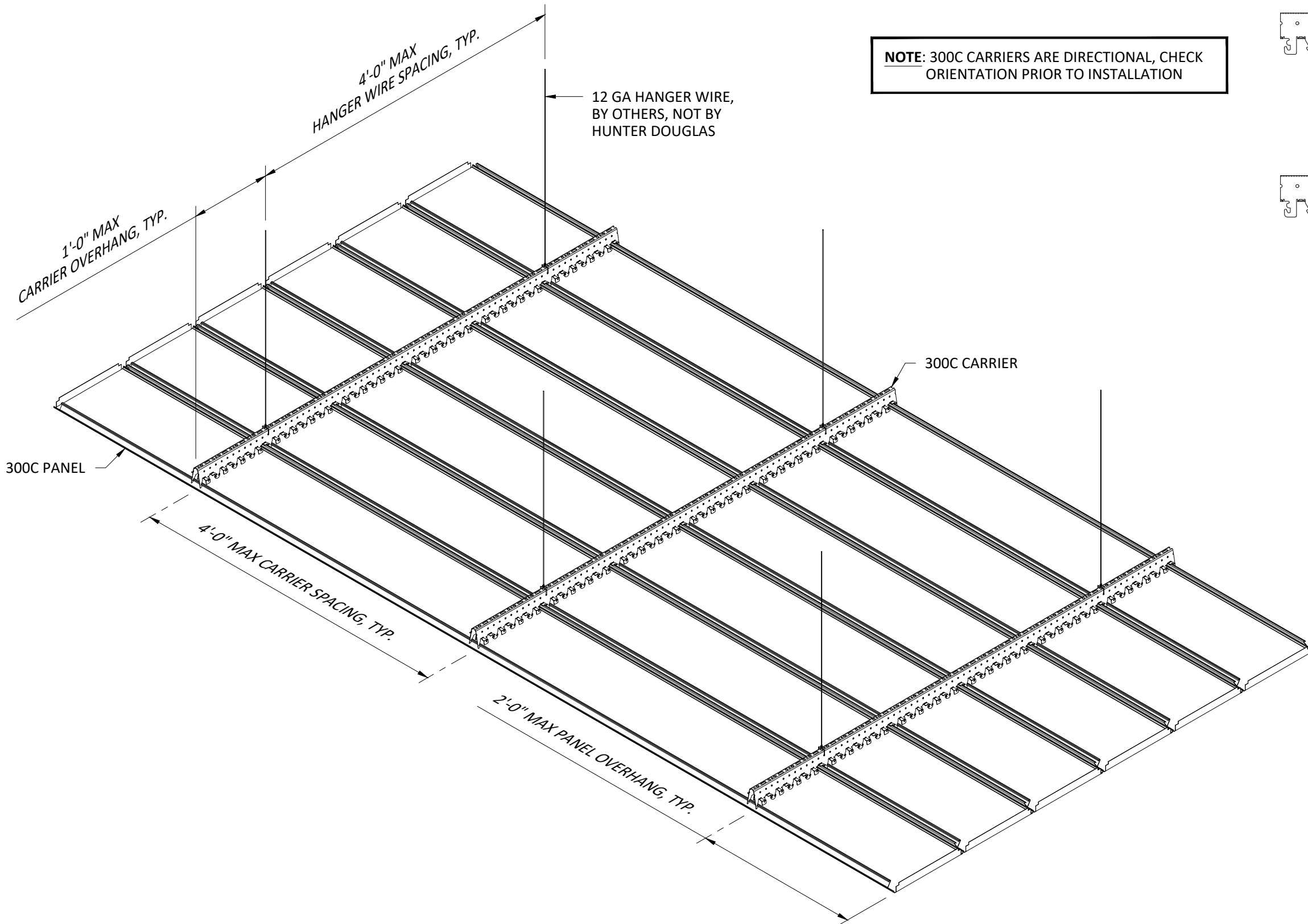

NOTE: 300C CARRIERS ARE DIRECTIONAL, CHECK ORIENTATION PRIOR TO INSTALLATION

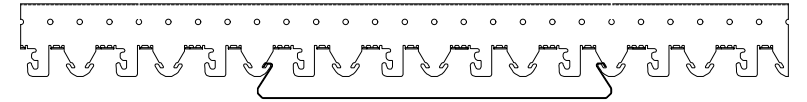

SIDE VIEW OF 300C CARRIER WITH PANEL

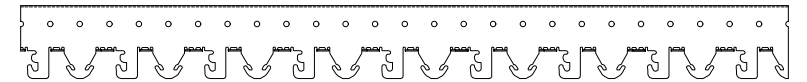

SIDE VIEW OF 300C CARRIER

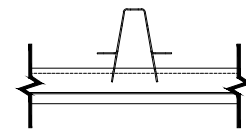

END VIEW OF 300C CARRIER WITH PANEL



END VIEW OF 300C CARRIER

300C CARRIER

MATERIAL: .040" ALUMINUM

FINISH: MATTE BLACK

PART LENGTH: 16'-0"

HunterDouglas 
Ceiling & Wall Products
 exclusively from CertainTeed

5015 Oakbrook Parkway, Suite 100
 Norcross, GA 30093
 O 800.366.4327
 F 770.806.0214
 CTSpecialtyCeilings.com

All rights reserved. This drawing is the property of CertainTeed Ceilings Corporation. It may not be copied or multiplied, neither wholly nor partly. It may not be submitted for perusal to third parties.

SPECIFICATIONS
 (unless noted otherwise)

MATERIAL: .028" ALUMINUM 300C PANEL | .040" ALUMINUM 300C CARRIER

FINISH: PAINT | POWDER COAT | DECORATED WOOD FINISH | WOOD VENEER | LUXACOTE

PERFORATION: NON-PERFORATED | #160

SUSPENSION SPECIFICATIONS

PROJECT: 300C PRODUCT SPECIFICATIONS

DRAWING NUMBER: 300C-A1.2

SCALE: NOT TO SCALE

DRAWN BY: HD ENGINEERING

DATE: 1/28/19

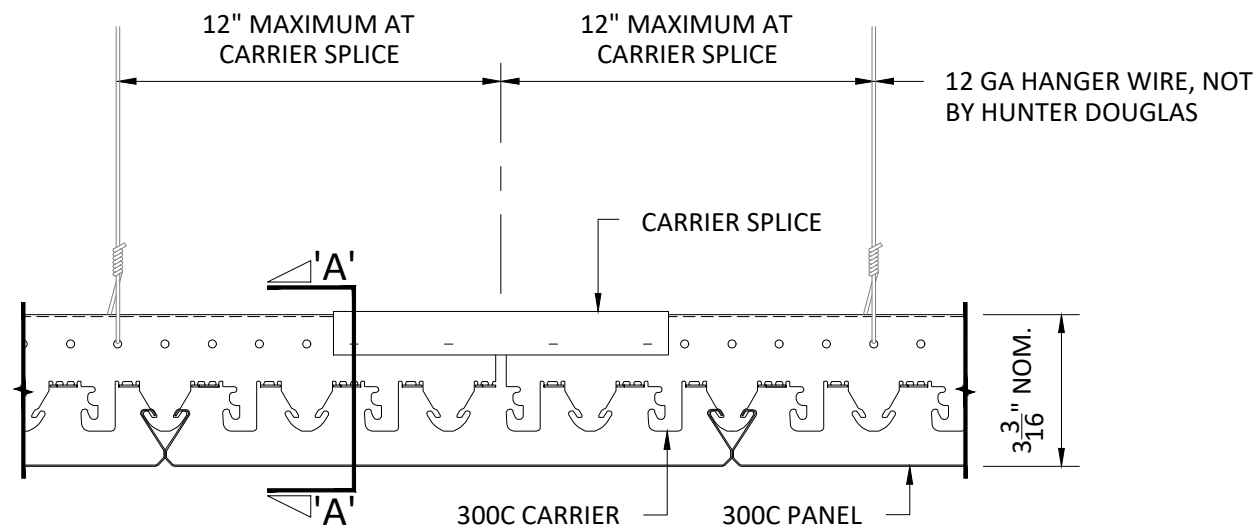

SECTION 'A' - 'A'

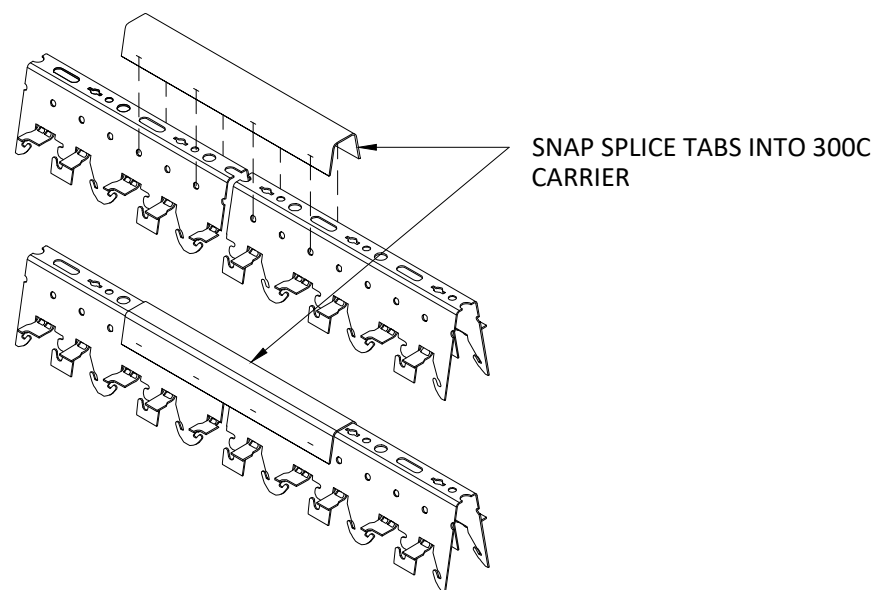

IF THE DESIRED CARRIER LENGTH EXCEEDS THE MAXIMUM OF 16'-0", USE A LUXALON CARRIER SPLICE, TO CONNECT TWO FACTORY CARRIER ENDS.

THE TABS OF THE SPLICE SNAP INTO THE HOLES IN THE CARRIER AND ADDITIONAL FIXING IS NOT NECESSARY. THE MODULE IS CONTINUED AUTOMATICALLY.

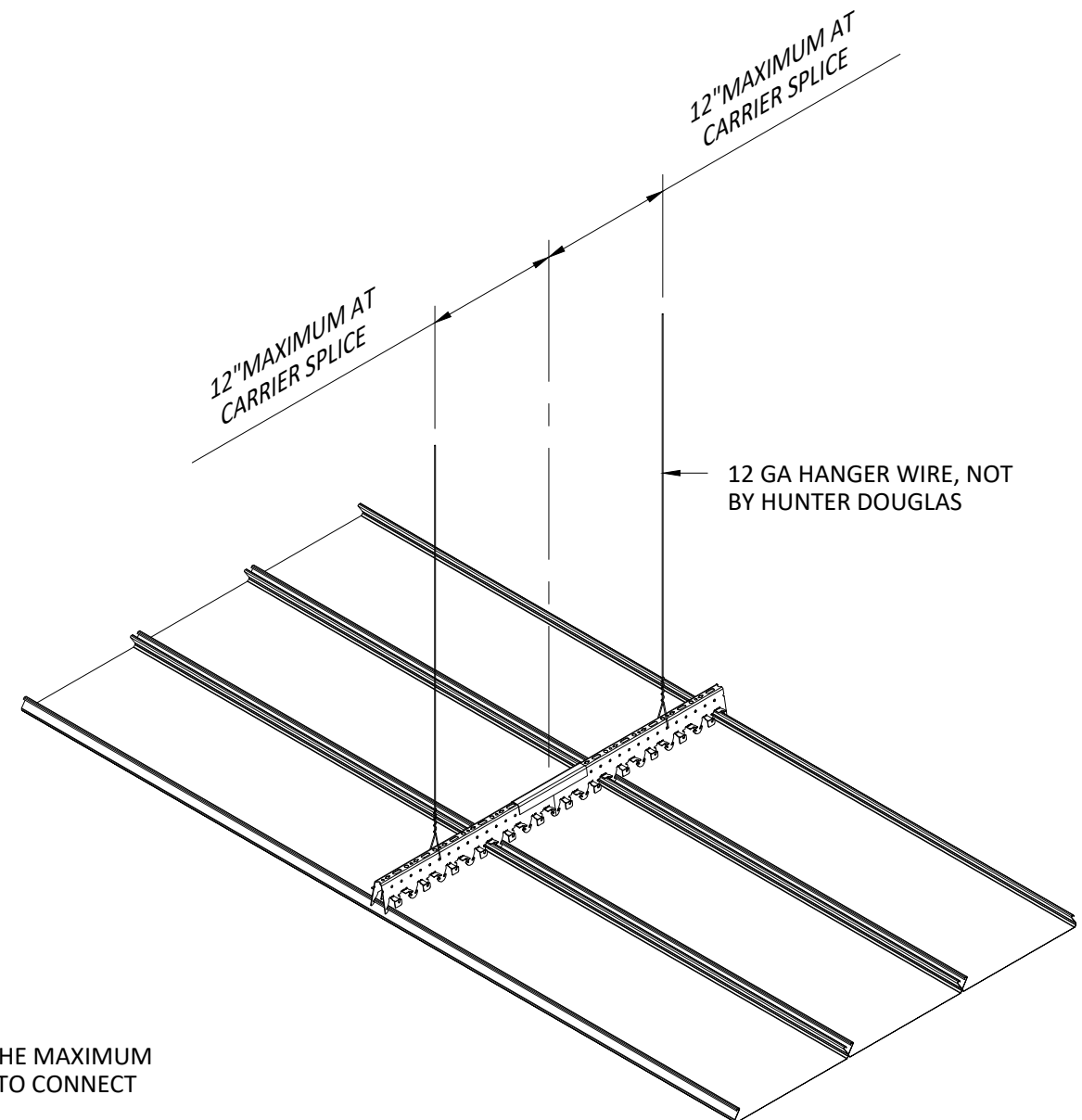

INTERIOR INSTALLATION

HunterDouglas 
Ceiling & Wall Products
exclusively from CertainTeed

5015 Oakbrook Parkway, Suite 100
Norcross, GA 30093
O 800.366.4327
F 770.806.0214
CTSpecialtyCeilings.com

All rights reserved. This drawing is the property of CertainTeed Ceilings Corporation. It may not be copied or multiplied, neither wholly nor partly. It may not be submitted for perusal to third parties.

SPECIFICATIONS

(unless noted otherwise)

MATERIAL: .028" ALUMINUM 300C PANEL | .040" ALUMINUM 300C CARRIER
FINISH: PAINT | POWDER COAT | DECORATED WOOD FINISH | WOOD
VENEER | LUXACOTE
PERFORATION: NON-PERFORATED | #160

CARRIER SPLICE

PROJECT: 300C PRODUCT SPECIFICATIONS
DRAWING NUMBER: 300C-A1.3
SCALE: 3" = 1'-0"
DRAWN BY: HD ENGINEERING
DATE: 1/28/19

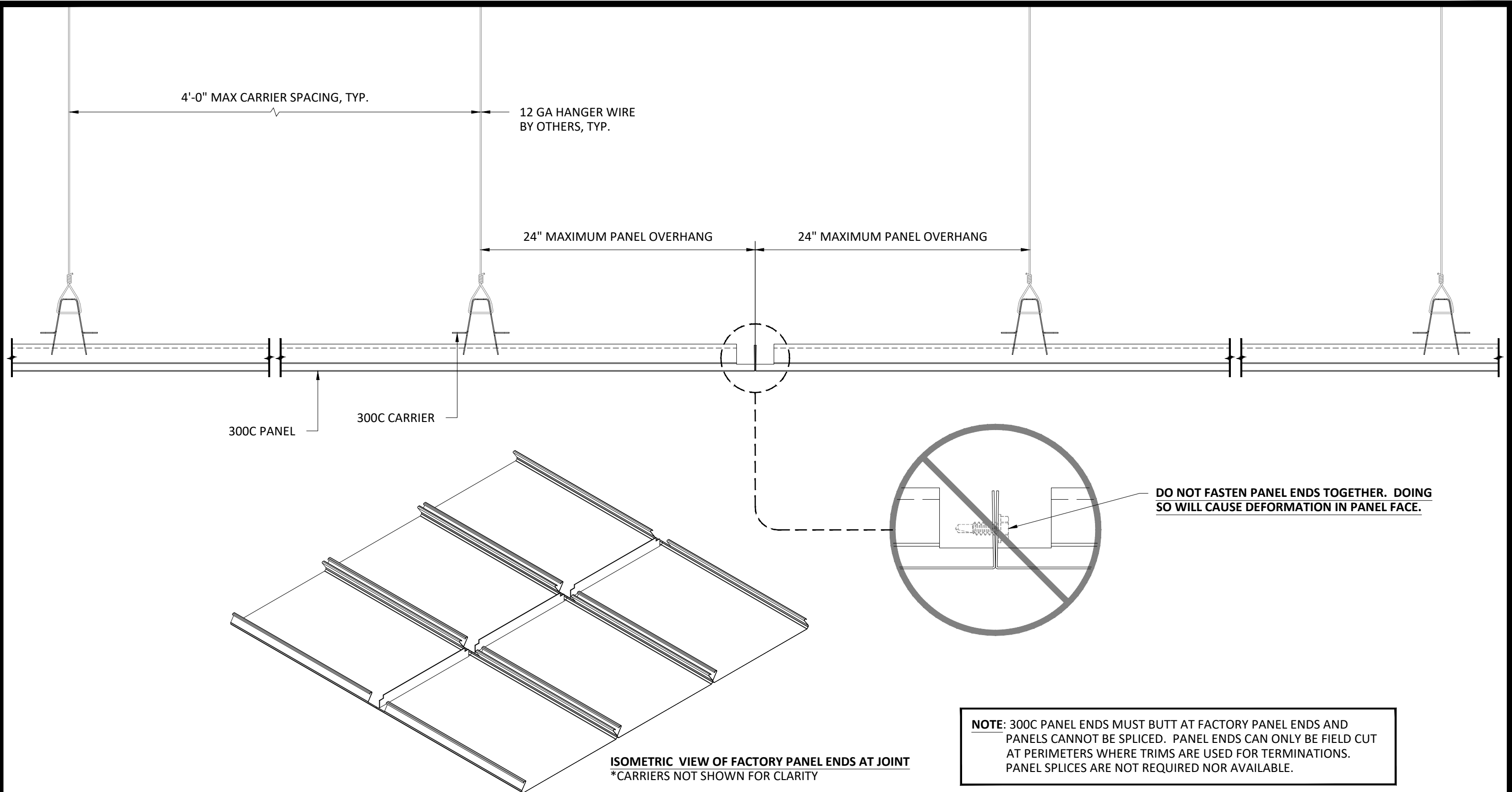

INTERIOR INSTALLATION

HunterDouglas 
Ceiling & Wall Products
exclusively from CertainTeed

5015 Oakbrook Parkway, Suite 100
Norcross, GA 30093
O 800.366.4327
F 770.806.0214
CTSpecialtyCeilings.com

All rights reserved. This drawing is the property of CertainTeed Ceilings Corporation. It may not be copied or multiplied, neither wholly nor partly. It may not be submitted for perusal to third parties.

SPECIFICATIONS (unless noted otherwise)

MATERIAL: .028" ALUMINUM 300C PANEL | .040" ALUMINUM 300C CARRIER
FINISH: PAINT | POWDER COAT | DECORATED WOOD FINISH | WOOD VENEER | LUXACOTE
PERFORATION: NON-PERFORATED | #160

PANEL BUTT JOINT

PROJECT: 300C PRODUCT SPECIFICATIONS
DRAWING NUMBER: 300C-A1.4
SCALE: 3" = 1'-0"
DRAWN BY: HD ENGINEERING
DATE: 1/28/19

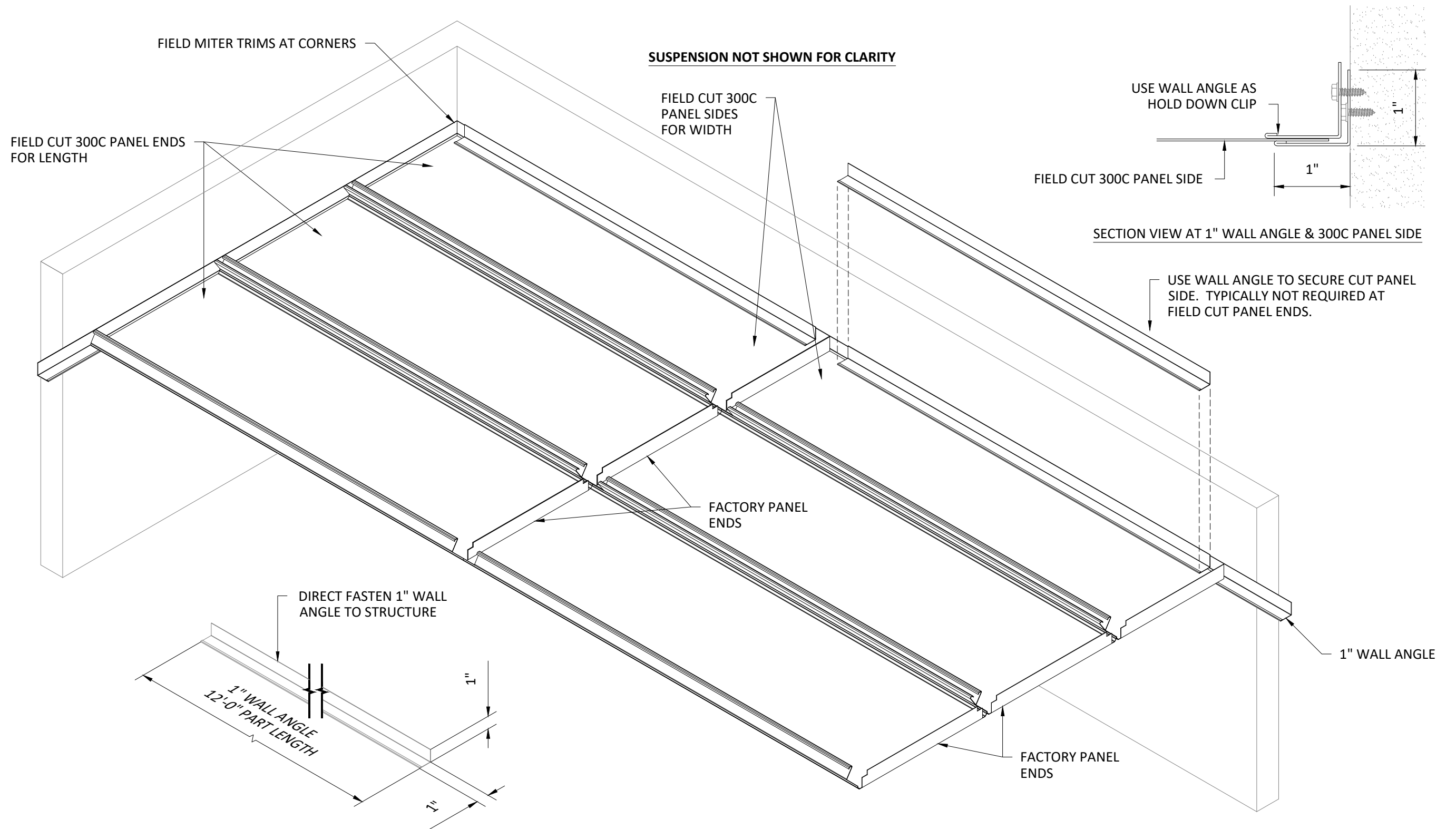

*VERTICAL SUPPORT OMITTED FOR CLARITY

INTERIOR INSTALLATION

HunterDouglas 
Ceiling & Wall Products
 exclusively from CertainTeed

5015 Oakbrook Parkway, Suite 100
 Norcross, GA 30093
 O 800.366.4327
 F 770.806.0214
 CTSpecialtyCeilings.com

All rights reserved. This drawing is the property of CertainTeed Ceilings Corporation. It may not be copied or multiplied, neither wholly nor partly. It may not be submitted for perusal to third parties.

SPECIFICATIONS

(unless noted otherwise)

MATERIAL: .028" ALUMINUM 300C PANEL | .040" ALUMINUM 300C CARRIER
 FINISH: PAINT | POWDER COAT | DECORATED WOOD FINISH | WOOD
 VENEER | LUXACOTE
 PERFORATION: NON-PERFORATED | #160

WALL ANGLE TRIM

PROJECT: 300C PRODUCT SPECIFICATIONS
 DRAWING NUMBER: 300C-A1.5
 SCALE: NOT TO SCALE
 DRAWN BY: HD ENGINEERING
 DATE: 1/28/19

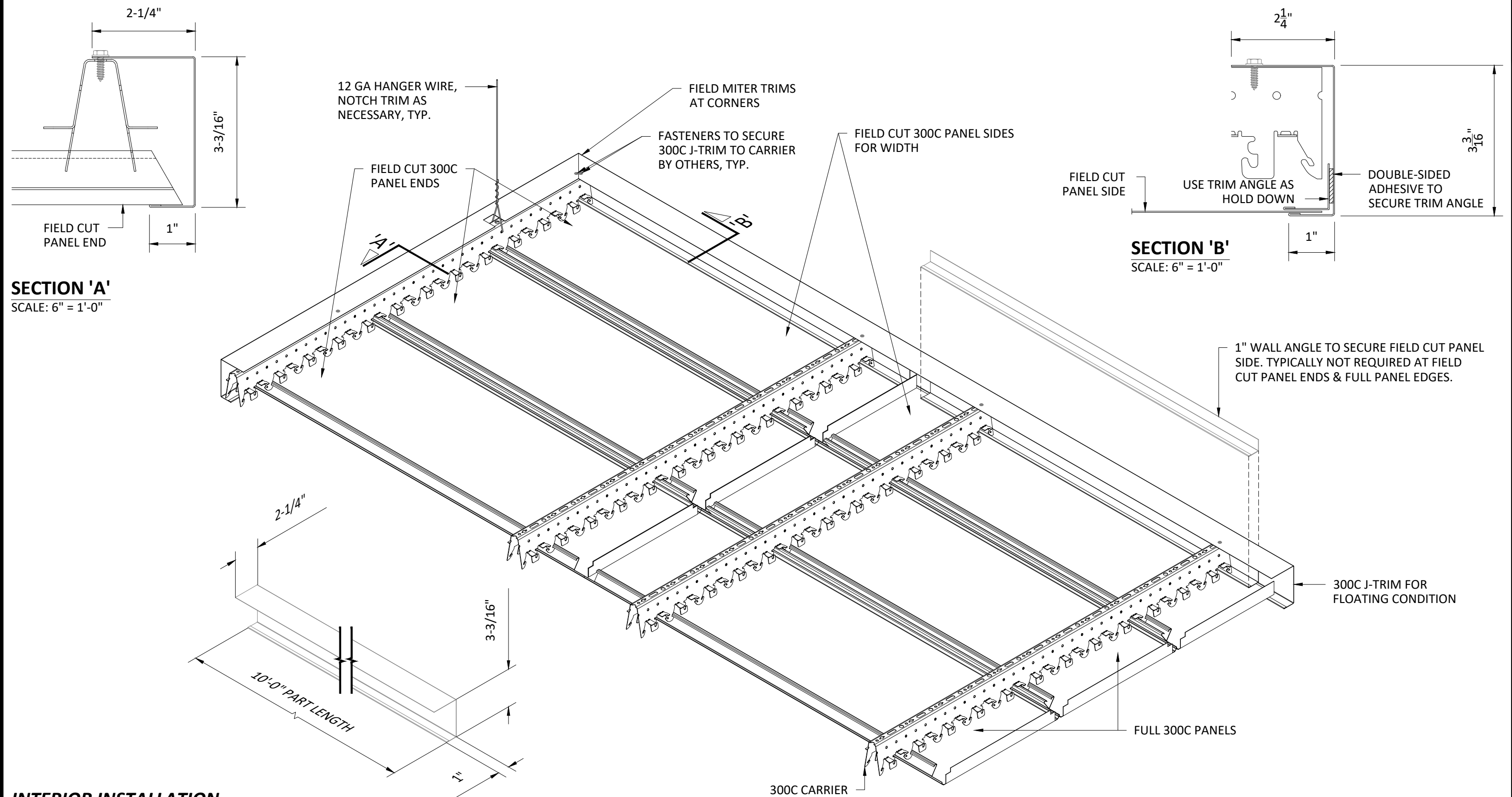

INTERIOR INSTALLATION

*VERTICAL SUPPORT OMITTED FOR CLARITY

HunterDouglas
Ceiling & Wall Products
exclusively from CertainTeed

5015 Oakbrook Parkway, Suite 100
Norcross, GA 30093
O 800.366.4327
F 770.806.0214
CTSpecialtyCeilings.com

All rights reserved. This drawing is the property of CertainTeed Ceilings Corporation. It may not be copied or multiplied, neither wholly nor partly. It may not be submitted for perusal to third parties.

SPECIFICATIONS

(unless noted otherwise)

MATERIAL: .028" ALUMINUM 300C PANEL | .040" ALUMINUM 300C CARRIER
FINISH: PAINT | POWDER COAT | DECORATED WOOD FINISH | WOOD VENEER | LUXACOTE
PERFORATION: NON-PERFORATED | #160

FLOATING TRIM

PROJECT: 300C PRODUCT SPECIFICATIONS
DRAWING NUMBER: 300C-A1.6
SCALE: NOT TO SCALE
DRAWN BY: HD ENGINEERING
DATE: 1/28/19

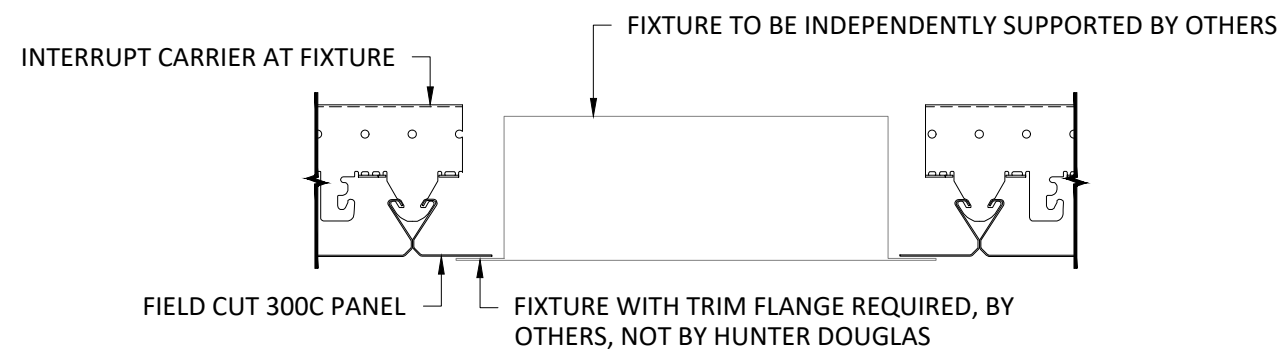
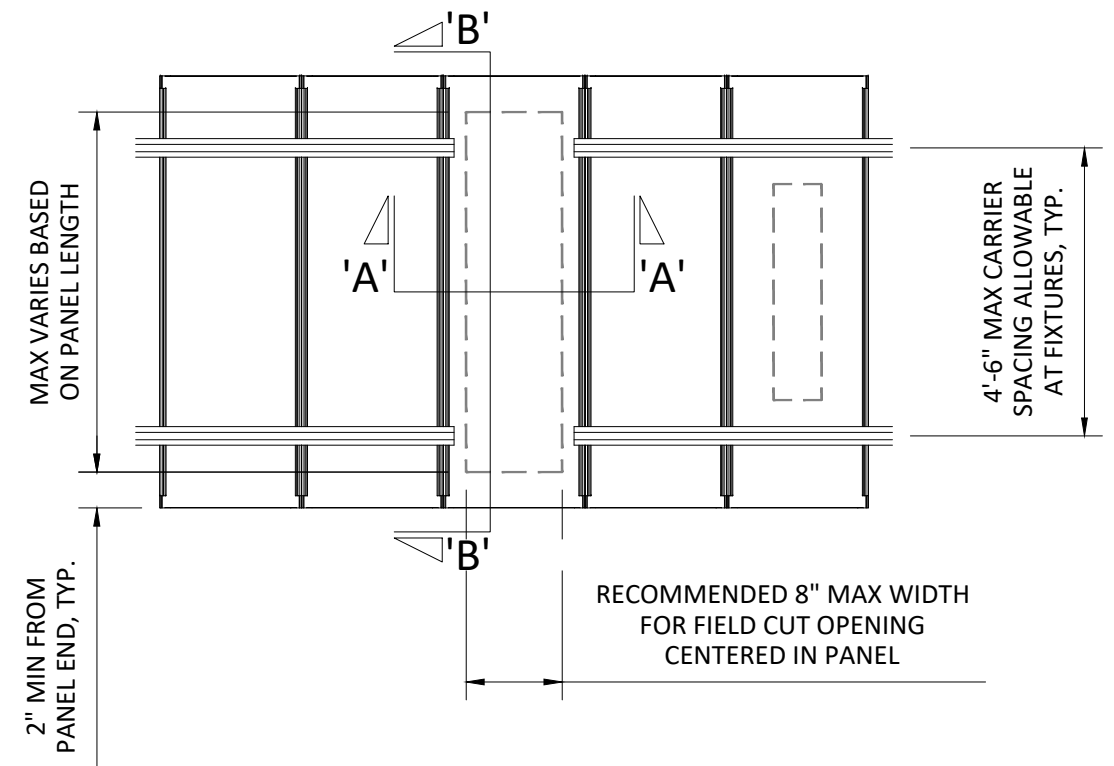
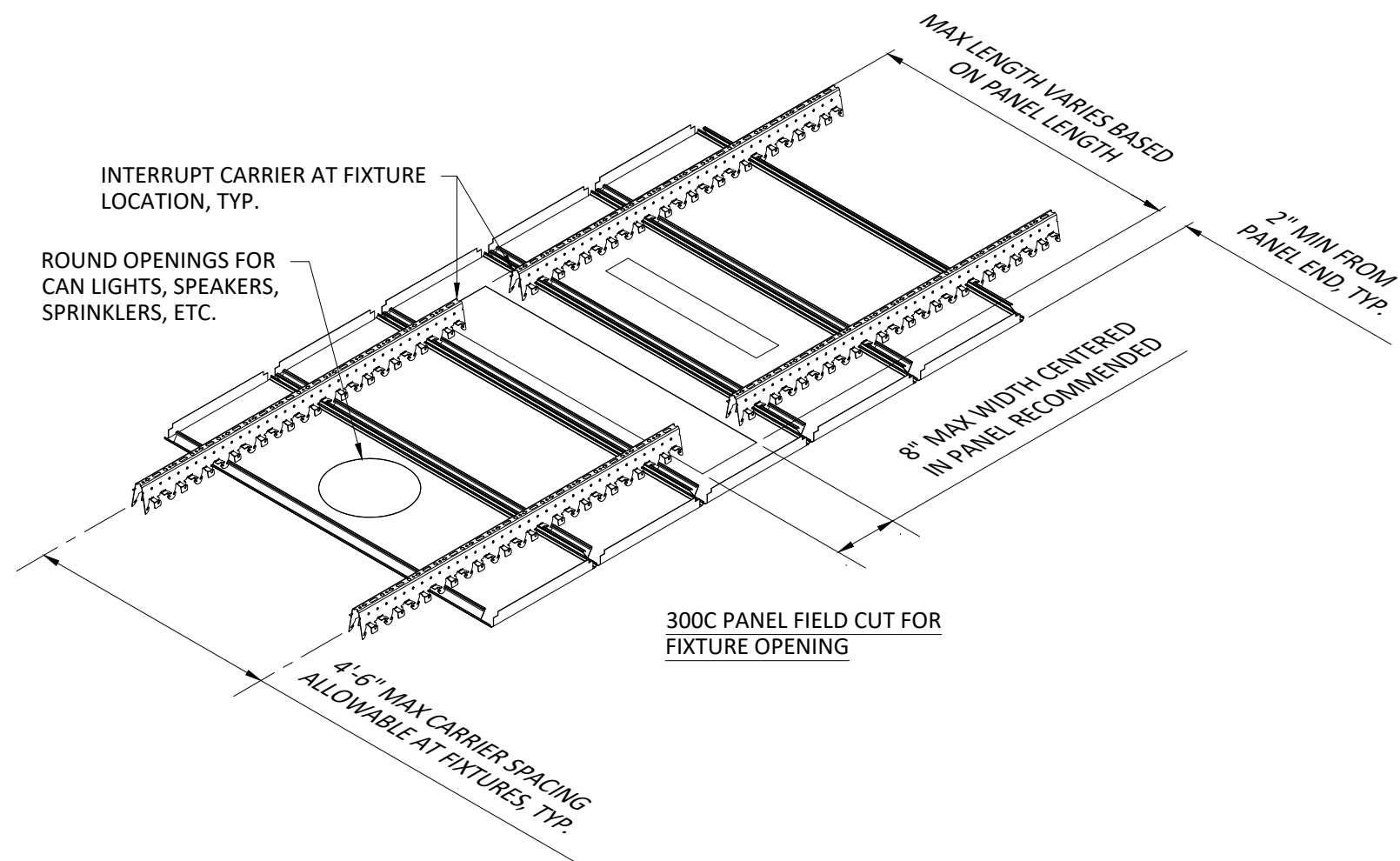

SECTION 'A' - 'A'

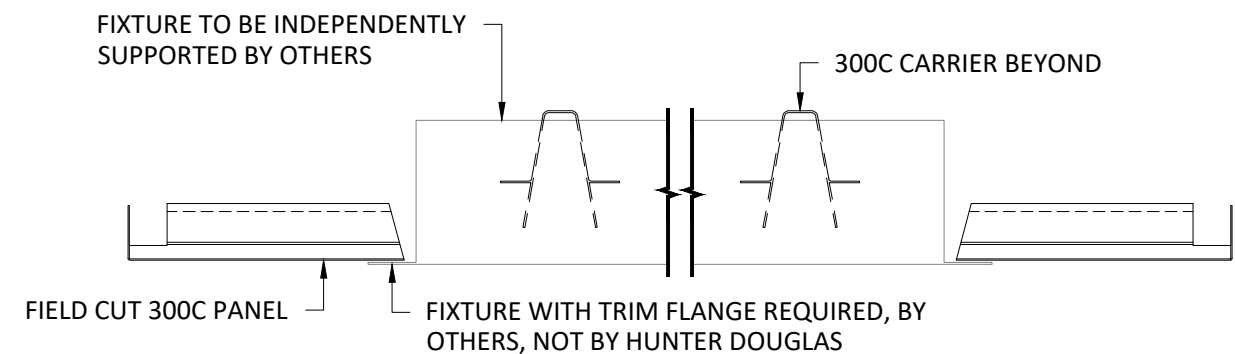

SECTION 'B' - 'B'

NOTE: ROUND OPENINGS LESS THAN EIGHT (8) INCHES DIAMETER TYPICALLY FIELD CUT INTO PANEL FACE, TRIM FOR ALL FIXTURES BY OTHERS NOT BY HUNTER DOUGLAS

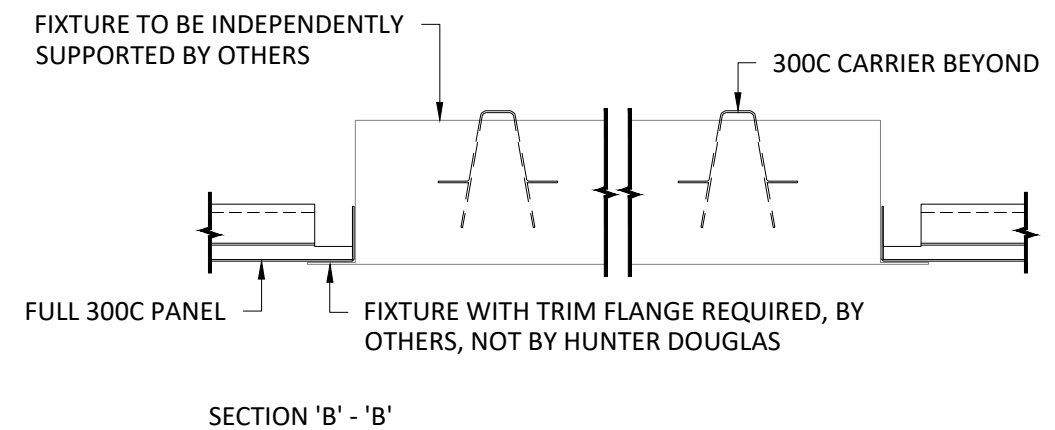
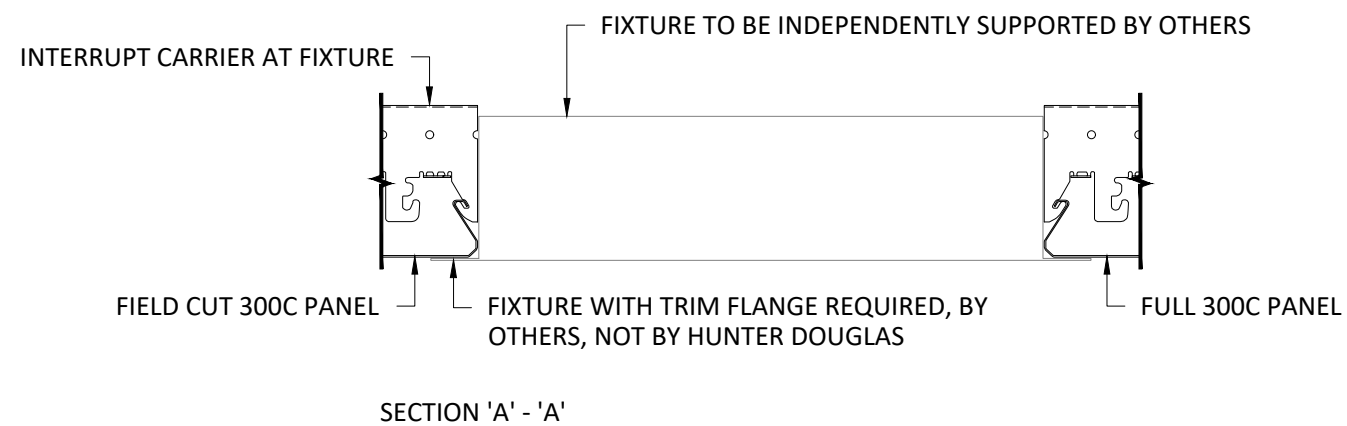
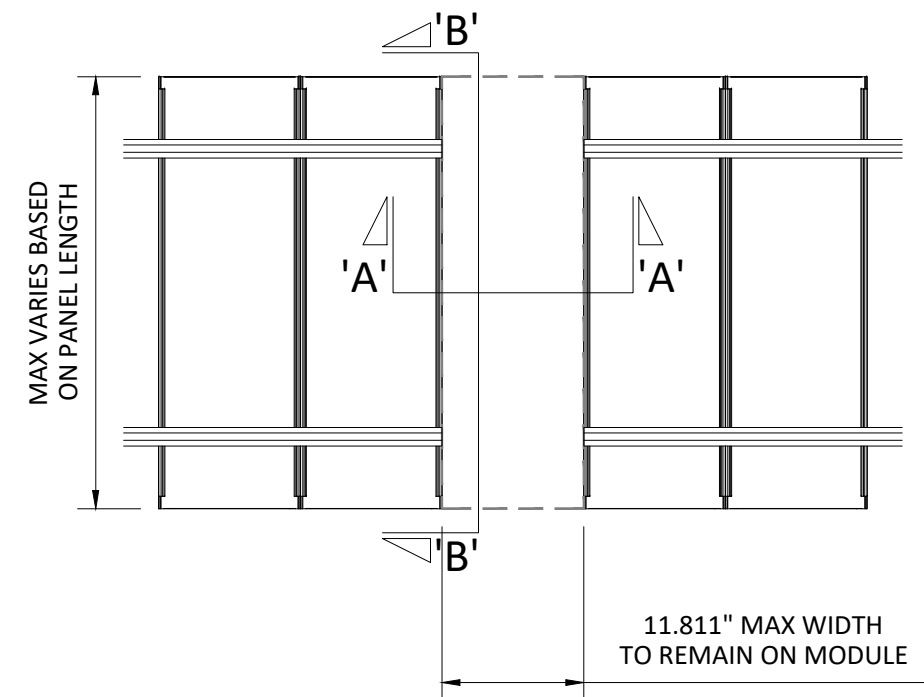
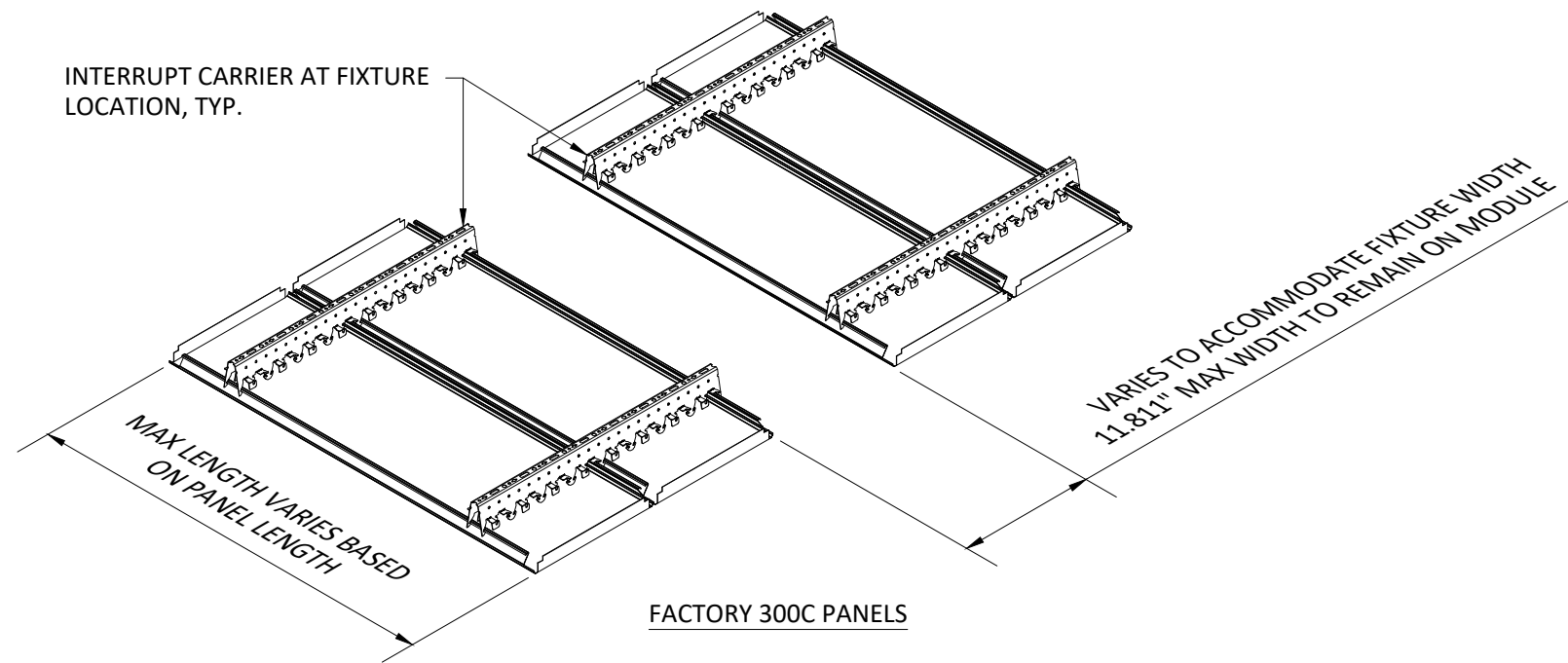

NOTE: FIXTURE WITH TRIM FLANGE NOT BY HUNTER DOUGLAS

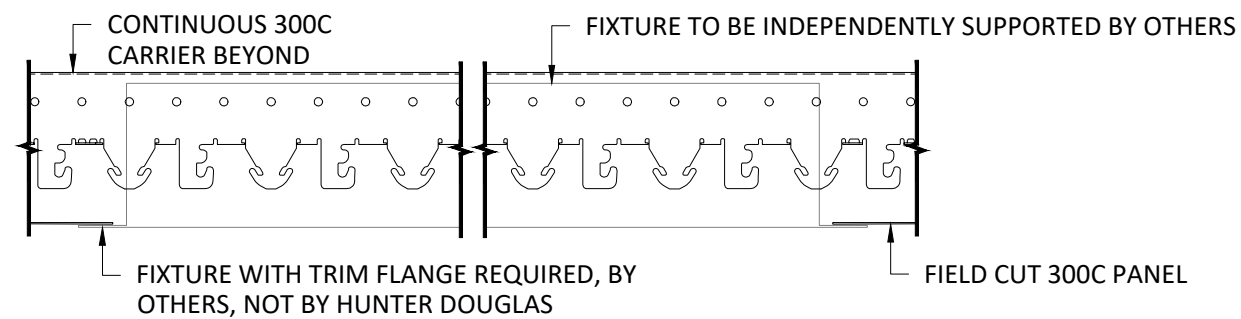
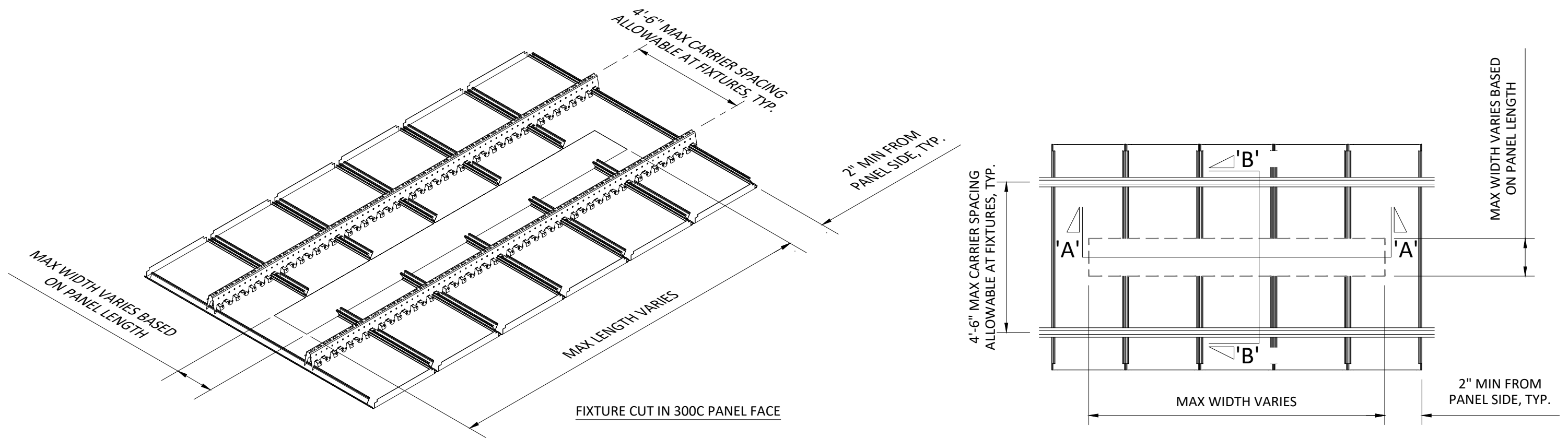

SECTION 'A' - 'A'

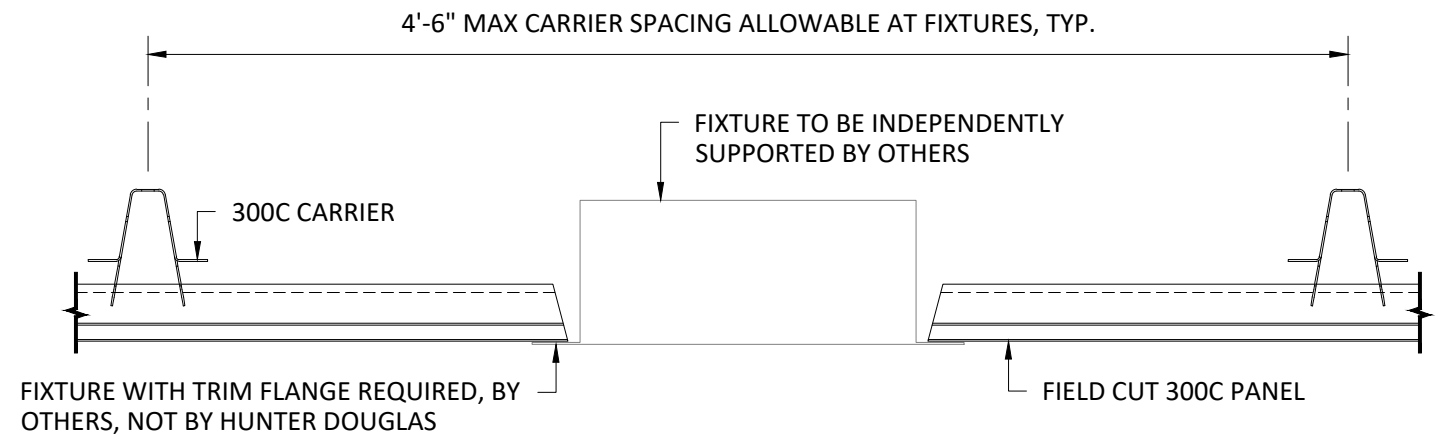

SECTION 'B' - 'B'

NOTE: ROUND OPENINGS LESS THAN EIGHT (8) INCHES DIAMETER TYPICALLY FIELD CUT INTO PANEL FACE, TRIM FOR ALL FIXTURES BY OTHERS NOT BY HUNTER DOUGLAS

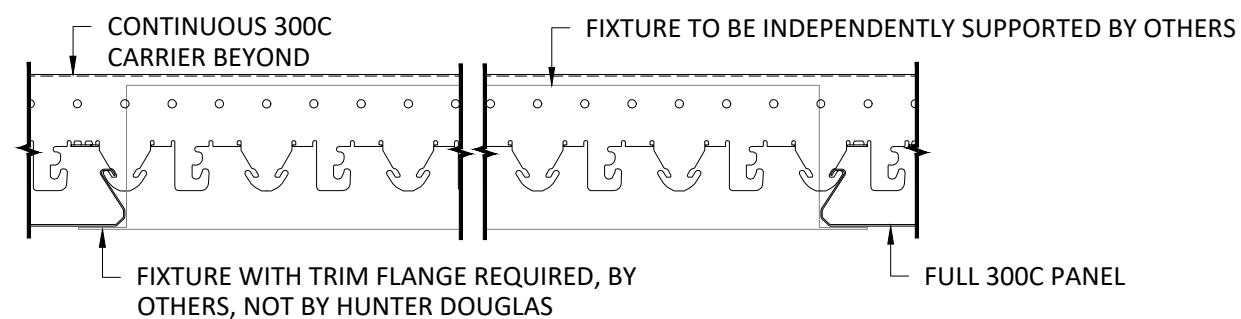
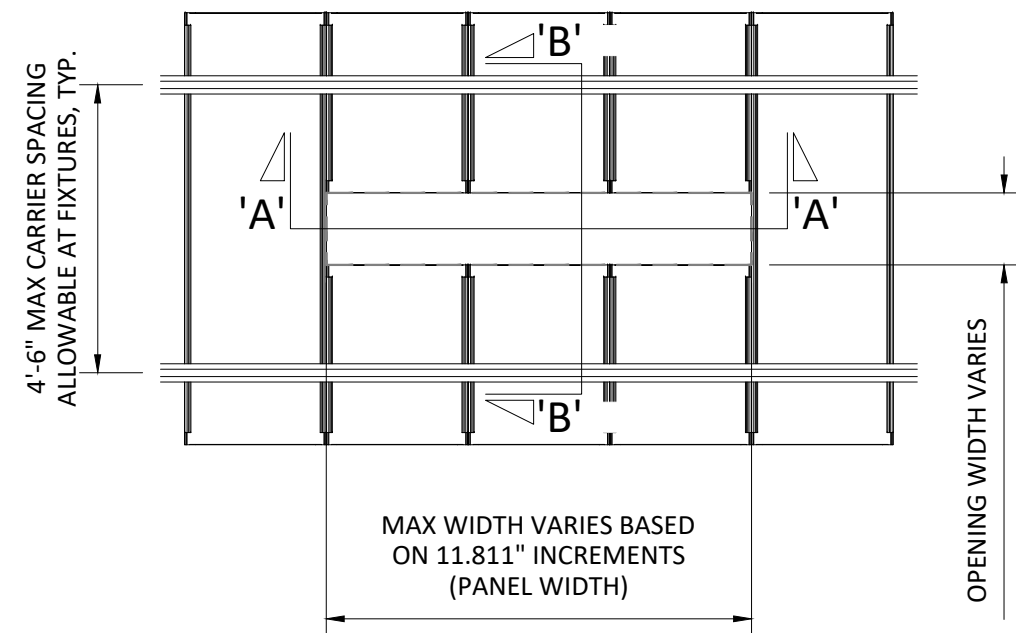
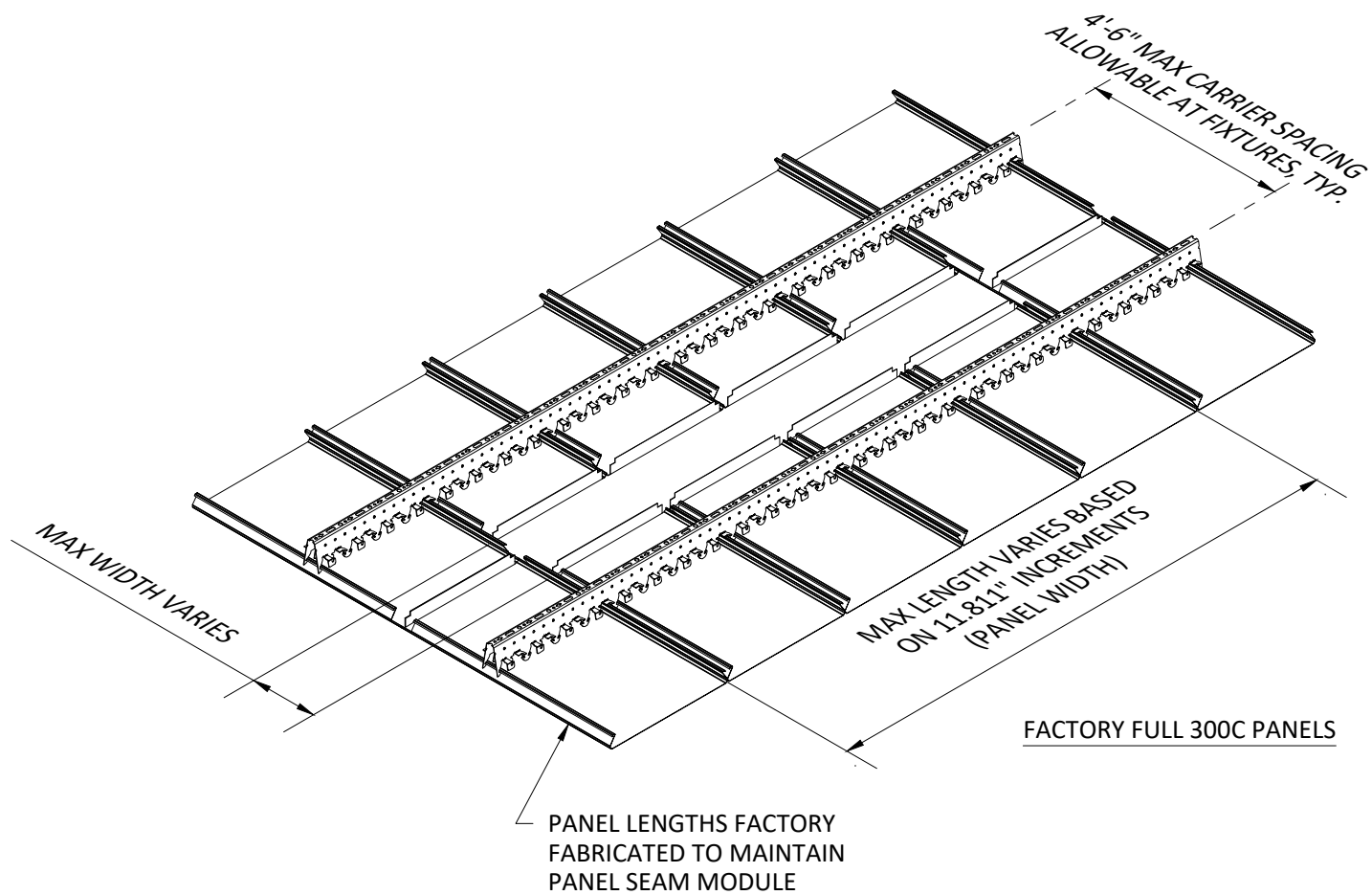

SECTION 'A' - 'A'

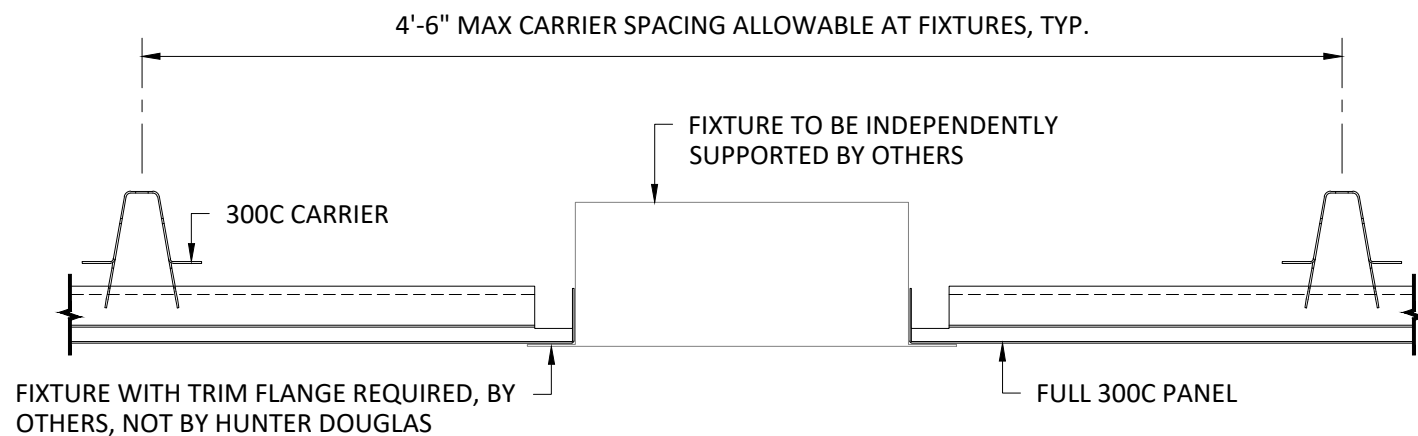

SECTION 'B' - 'B'

NOTE: FIXTURE WITH TRIM FLANGE NOT BY HUNTER DOUGLAS

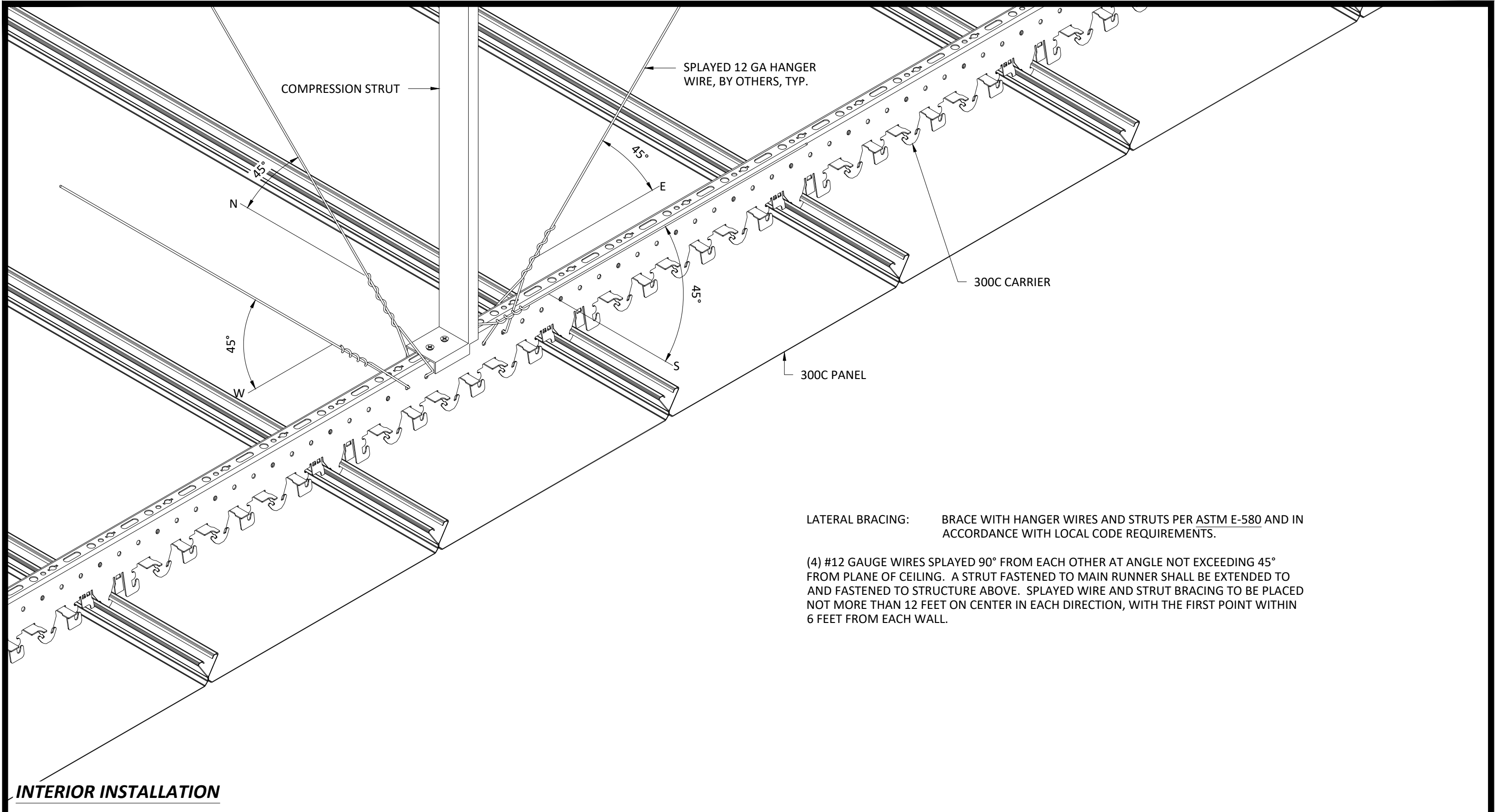

SPECIFICATIONS
(unless noted otherwise)

MATERIAL: .028" ALUMINUM 300C PANEL | .040" ALUMINUM 300C CARRIER
FINISH: PAINT | POWDER COAT | DECORATED WOOD FINISH | WOOD
VENEER | LUXACOTE
PERFORATION: NON-PERFORATED | #160

SEISMIC SPECIFICATIONS

PROJECT: 300C PRODUCT SPECIFICATIONS
DRAWING NUMBER: 300C-A1.11
SCALE: NOT TO SCALE
DRAWN BY: HD ENGINEERING
DATE: 1/28/19